

REV.	ECN. NO.	APPD.

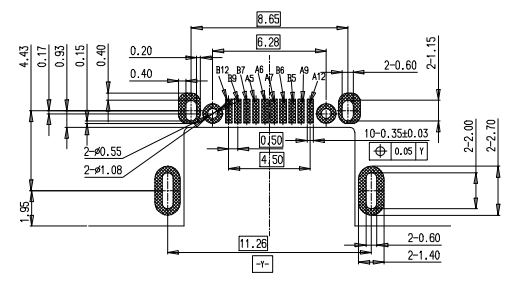
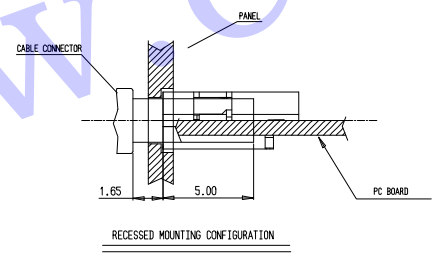
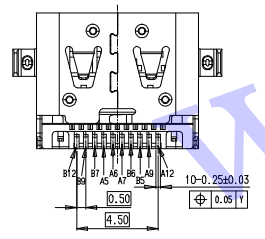
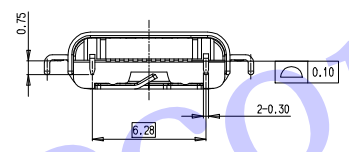
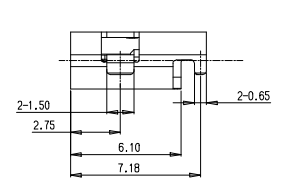
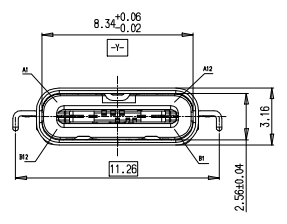
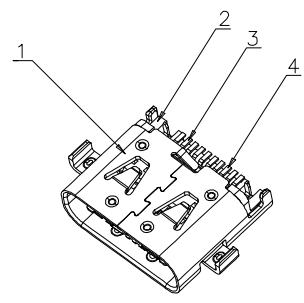
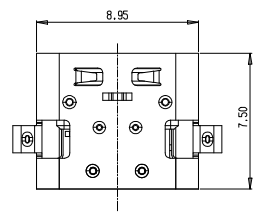

NOTES:

- Electrical characteristics:
 - Contact current rating:
A current of 3.0A shall be applied collectively to VBUS pins and 1.25A applied to the VCONN pin with the return path through the corresponding GND pins.
A MIN 0.25A shall be applied individually to all other contacts.
 - Contact resistance:
40 Milliohms (MAX) initial for VBUS, GND and all other contacts.
Maximum change (delta) of +10 Milliohms after environmental stresses.
 - Dielectric withstanding voltage : 100 V AC MIN (RMS).
 - Insulation resistance: 100 MEGOHMS MIN.
- Mechanical characteristics:
 - Connector insertion force: 5~20N at a maximum rate of 12.5mm per minute.
 - Connector extraction force: 8~20N up to 1000 mating cycles, and 6~20N after the specified insertion/extraction or durability cycles at a maximum rate of 12.5mm per minute
 - Durability: 10000 cycles minimum.
 - Operating temperature: -55°C TO +85°C
- The connector is rohs compliant and halogen free compliant.

PIN ASSIGNMENT			
Pin No.	Signal Name	Pin No.	Signal Name
A1		B12	GND
A2		B11	
A3		B10	
A4		B9	VBUS
A5	CC1	B8	
A6	D+	B7	D-
A7	D-	B6	D+
A8		B5	CC2
A9	VBUS	B4	
A10		B3	
A11		B2	
A12	GND	B1	

RECOMMENDED P.C.B. LAYOUT (COMPONENT SIDE)
 PCB THICKNESS: 0.80±0.05mm
 DEFAULT TOLERANCE: ±0.05

X. ±0.50	X.* ± 2°	UNITS mm
.X ±0.30	.X* ± 1°	
.XX ±0.10	.XX* ± 0.5°	MAT'L /
.XXX ± 0.05		
THESE DRAWINGS AND SPECIFICATIONS ARE THE PROPERTY OF CHUANGYUE TECHNOLOGY CO.,LTD. AND SHALL NOT BE REPRODUCED, COPIED OR USED IN ANY MANNER WITHOUT THE PRIOR WRITTEN CONSENT OF CHUANGYUE TECHNOLOGY CO., LTD		FINISH /
Q'TY /		

深圳市创粤科技有限公司

TITLE:
Type-c母座10pin沉板0.75单排SMT 两脚插板

DWG NO.:
CY-QTF2-10PC-075

APPD: _____

CHKD: _____

DR: Steven.Xie 2018/10/07

SCALE	SHEET	REV.
1/1	1/1	A1